

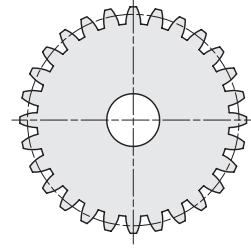

RUOTE DENTATE CILINDRICHE TEMPERATE AD INDUZIONE CYLINDRICAL GEARS WITH HARDENED TEETH

MODULO 2
ANGOLO DI PRESSIONE 20°

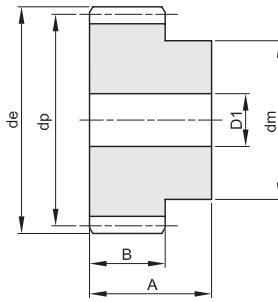

A	B
35	20

Materiale acciaio C45

Z	codice	de	dp	dm	D1	Kg.
12	402020012	28	24	18	10	0,08
15	402020015	34	30	24	10	0,14
18	402020018	40	36	25	10	0,19
20	402020020	44	40	30	10	0,26
24	402020024	52	48	35	12	0,36
25	402020025	54	50	35	12	0,39
30	402020030	64	60	40	14	0,55
36	402020036	76	72	45	14	0,78
40	402020040	84	80	50	14	0,97
50	402020050	104	100	70	16	1,62
60	402020060	124	120	70	16	2,16

Z	codice	de	dp	dm	D1	Kg.



RUOTE DENTATE CILINDRICHE TEMPERATE AD INDUZIONE CYLINDRICAL GEARS WITH HARDENED TEETH

MODULO 2,5
ANGOLO DI PRESSIONE 20°

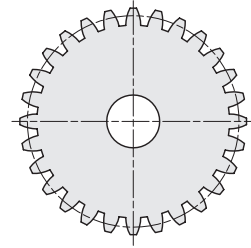
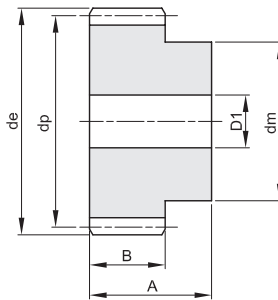

A	B
45	25

Materiale acciaio C45

Z	codice	de	dp	dm	D1	Kg.
12	402025012	35	30	22	10	0,17
15	402025015	42,5	37,5	30	10	0,30
18	402025018	50	45	35	12	0,42
20	402025020	55	50	40	12	0,54
24	402025024	65	60	45	14	0,74
25	402025025	67,5	62,5	50	14	0,85
30	402025030	80	75	55	14	1,18
36	402025036	95	90	60	16	1,61
40	402025040	105	100	70	16	2,06
50	402025050	130	125	80	20	3,07
60	402025060	155	150	100	20	4,57

Z	codice	de	dp	dm	D1	Kg.



RUOTE DENTATE CILINDRICHE TEMPERATE AD INDUZIONE CYLINDRICAL GEARS WITH HARDENED TEETH

MODULO 3
ANGOLO DI PRESSIONE 20°

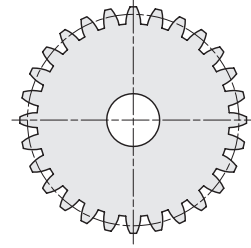
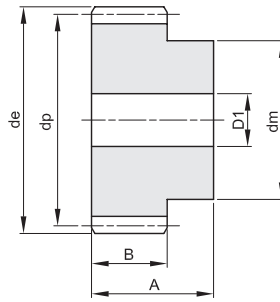

A	B
50	30

Materiale acciaio C45

Z	codice	de	dp	dm	D1	Kg.
12	402030012	42	36	27	12	0,28
15	402030015	51	45	35	12	0,47
18	402030018	60	54	45	14	0,72
20	402030020	66	60	45	14	0,84
24	402030024	78	72	50	16	1,18
25	402030025	81	75	60	16	1,39
30	402030030	96	90	60	16	1,85
36	402030036	114	108	70	20	2,62
40	402030040	126	120	80	20	3,31

Z	codice	de	dp	dm	D1	Kg.



RUOTE DENTATE CILINDRICHE TEMPERATE AD INDUZIONE CYLINDRICAL GEARS WITH HARDENED TEETH

MODULO 4
ANGOLO DI PRESSIONE 20°

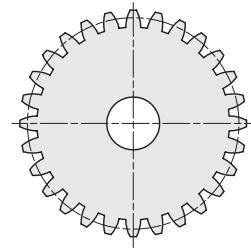
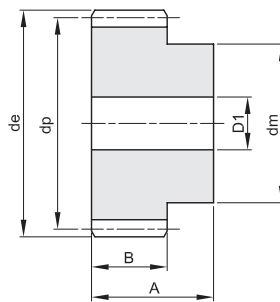

A	B
60	40

Materiale acciaio C45

Z	codice	de	dp	dm	D1	Kg.
12	402040012	56	48	35	14	0,63
15	402040015	68	60	45	14	1,05
18	402040018	80	72	50	16	1,47
20	402040020	88	80	60	16	1,90
24	402040024	104	96	75	20	2,79
25	402040025	108	100	75	20	2,98
30	402040030	128	120	75	20	4,06
36	402040036	152	144	80	25	5,63

Z	codice	de	dp	dm	D1	Kg.



RUOTE DENTATE CILINDRICHE TEMPERATE AD INDUZIONE CYLINDRICAL GEARS WITH HARDENED TEETH

MODULO 5
ANGOLO DI PRESSIONE 20°

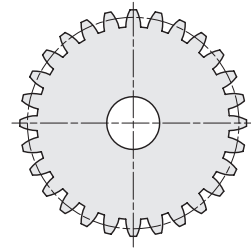
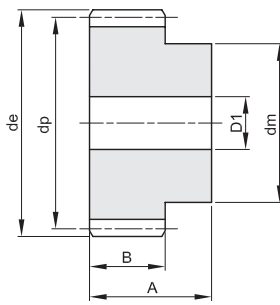

A	B
75	50

Materiale acciaio C45

Z	codice	de	dp	dm	D1	Kg.
12	402050012	70	60	45	20	1,21
15	402050015	85	75	60	20	2,07
18	402050018	100	90	70	20	3,02
20	402050020	110	100	80	20	3,83
24	402050024	130	120	90	20	5,44
25	402050025	135	125	90	20	5,82
30	402050030	160	150	110	25	8,44

Z	codice	de	dp	dm	D1	Kg.



RUOTE DENTATE CILINDRICHE TEMPERATE AD INDUZIONE CYLINDRICAL GEARS WITH HARDENED TEETH

MODULO 6
ANGOLO DI PRESSIONE 20°

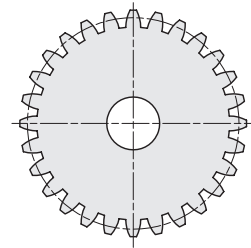
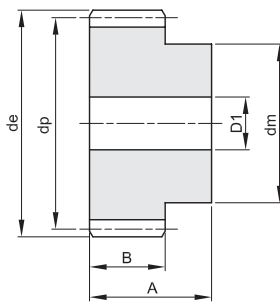

A	B
80	60

Materiale acciaio C45

Z	codice	de	dp	dm	D1	Kg.
12	402060012	84	72	54	20	1,98
15	402060015	102	90	70	20	3,29
16	402060016	108	95	75	20	3,80
18	402060018	120	108	80	20	4,76
20	402060020	132	120	90	20	5,99
24	402060024	156	144	110	25	8,70
25	402060025	162	150	110	25	9,33

Z	codice	de	dp	dm	D1	Kg.



CREMAGLIERE INTESTATE PER IL MONTAGGIO CONTINUO - ANGOLO DI PRESSIONE 20°

RACKS-CONTINUOUS MOUNTING - PRESSURE ANGLE 20°

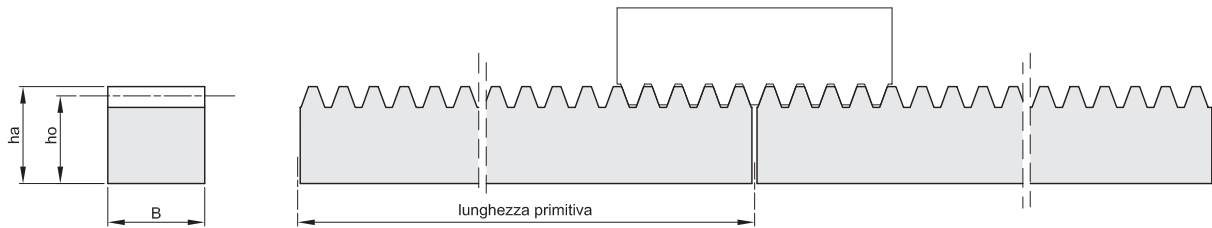

Materiale acciaio C45

modulo x lunghezza	codice	lunghezza primitiva	denti	B x ha	ho	Kg.
1 x 500	490110050	499,51	159	15 x 15	14	0,80
1 x 1000	490110100	1002,17	319	15 x 15	14	1,60
1 x 2000	490110200	2001,19	637	15 x 15	14	3,30
1 x 3000	490110300	3000,22	955	15 x 15	14	4,90
1,5 x 500	490115050	504,22	107	17 x 17	15,5	1,00
1,5 x 1000	490115100	1003,74	213	17 x 17	15,5	2,10
1,5 x 2000	490115200	2002,77	425	17 x 17	15,5	4,10
1,5 x 3000	490115300	3001,79	637	17 x 17	15,5	6,10
2 x 500	490120050	502,65	80	20 x 20	18	1,40
2 x 1000	490120100	1005,31	160	20 x 20	18	2,80
2 x 2000	490120200	2004,34	319	20 x 20	18	5,60
2 x 3000	490120300	3003,36	478	20 x 20	18	8,40
2,5 x 500	490125050	502,65	64	25 x 25	22,5	2,20
2,5 x 1000	490125100	1005,31	128	25 x 25	22,5	4,40
2,5 x 2000	490125200	2002,77	255	25 x 25	22,5	8,70
2,5 x 3000	490125300	3000,22	382	25 x 25	22,5	11,90
3 x 500	490130050	508,94	54	30 x 30	27	3,20
3 x 1000	490130100	1008,45	107	30 x 30	27	6,30
3 x 2000	490130200	2007,48	213	30 x 30	27	12,60
3 x 3000	490130300	3006,50	319	30 x 30	27	18,60
4 x 1000	490440100	1005,31	80	30 x 30	26	6,00
4 x 2000	490440200	2010,62	160	30 x 30	26	11,94
4 x 500	490140050	502,65	40	40 x 40	36	5,60
4 x 1000	490140100	1005,31	80	40 x 40	36	11,20
4 x 2000	490140200	2010,62	160	40 x 40	36	22,40
4 x 3000	490140300	3003,36	239	40 x 40	36	31,30
5 x 500	490150050	502,65	32	50 x 50	45	8,70
5 x 1000	490150100	1005,31	64	50 x 50	45	17,50
5 x 2000	490150200	2010,62	128	50 x 50	45	35,00
5 x 3000	490150300	3000,22	191	50 x 50	45	45,30
6 x 1000	490160100	1017,88	54	60 x 60	54	25,20
6 x 2000	490160200	2016,90	107	60 x 60	54	50,40
8 x 1000	490180100	1005,31	40	80 x 80	72	44,00
8 x 2000	490180200	2010,62	80	80 x 80	72	89,00